

Total Pitch Tolerances		Normal Dimension Tolerances	
0~30	±0.20	0~30	±0.25
over 30~53	±0.25	over 30~53	±0.30
over 53~70	±0.30	over 53~70	±0.35
over 70~90	±0.35	over 70~90	±0.44
over 90~115	±0.44	over 90~115	±0.55
over 115~150	±0.55	over 115~150	±0.70
over 150~200	±0.70	over 150~200	±0.85
over 200~250	±0.85	over 200~250	±1.00
over 250~320	±1.00	over 250~320	±1.20

NOTES 1:

UL Standard :

1. Rating: 150V 8A
2. Insulation Withstands Voltage:  
AC 1500V at 1 minute
3. Using Temperature Range:  
-40°C~+115°C

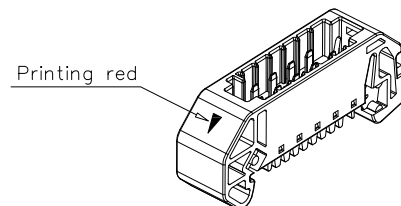
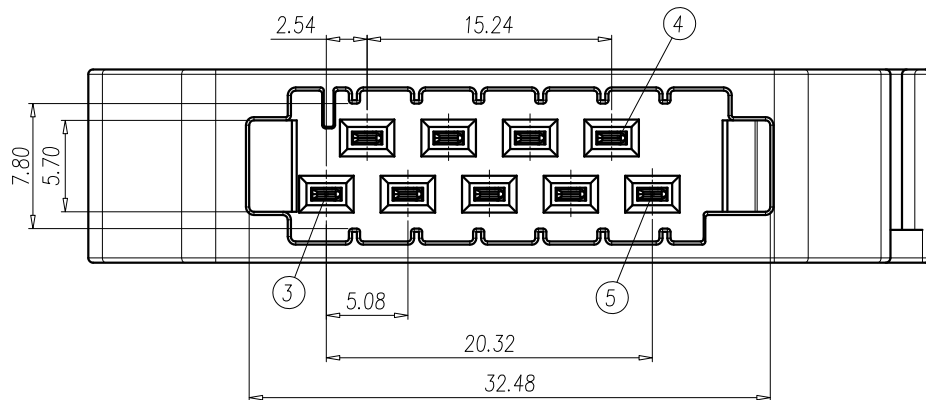

IEC Standard:

1. Rating: 250V 14A
2. Rate Impulse Voltage: 2500V
3. Insulation Resistance:  
500M Ω or more at DC500V
4. Material Group : I
5. Pollution Degree : 2
6. Overvoltage Category: II
7. Using Temperature Range:  
-40°C~+120°C

NOTES 2:

1. RoHS compliance

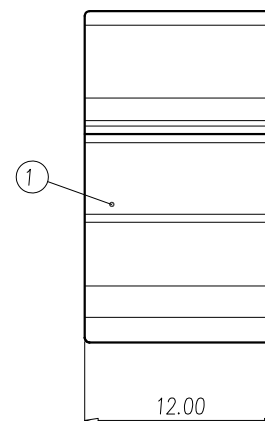
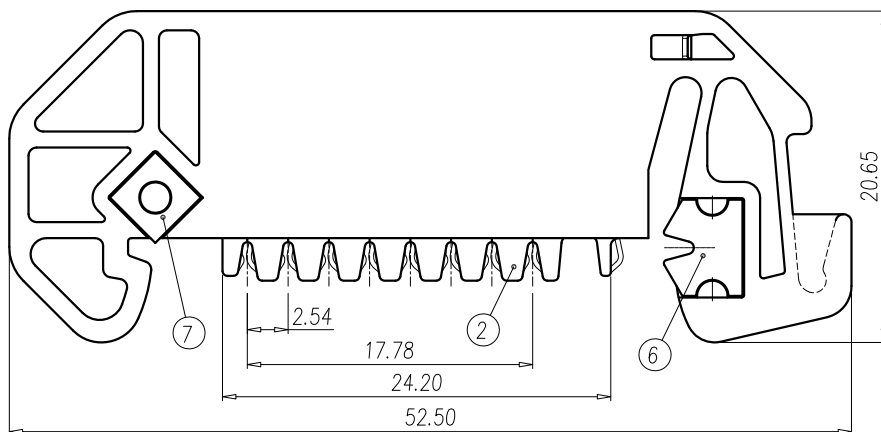

7	CLAMP 5	STEEL	
6	CLAMP 4	STEEL	
5	CLAMP 3	COPPER ALLOY	Gold Plated
4	CLAMP 2	COPPER ALLOY	Gold Plated
3	CLAMP 1	COPPER ALLOY	Gold Plated
2	HOUSING 2	PA66	UL94-V0 BLACK
1	HOUSING 1	PA66	UL94-V0 BLACK
ITEM	NAME OF PART	MATERIAL	NOTES

DWG.	ZW	DATE	2017.11.03	UNITS	MM	SHEET/OF	1 / 1
CHK.		DATE		SCALE	3:1 ( : )		
APP.		DATE		NAME	BS-210		
REV.	CONTENT	CHK.	DATE	DINKLE ENTERPRISE CO.,LTD	DWG NO.	SP-03-BS210000	



REV.

CONTENT

CHK.

DATE



DINKLE

ENTERPRISE CO.,LTD

DWG NO.

SP-03-BS210000